

TEMPERATURE SOLUTIONS

I-TT-M-100-1K Series

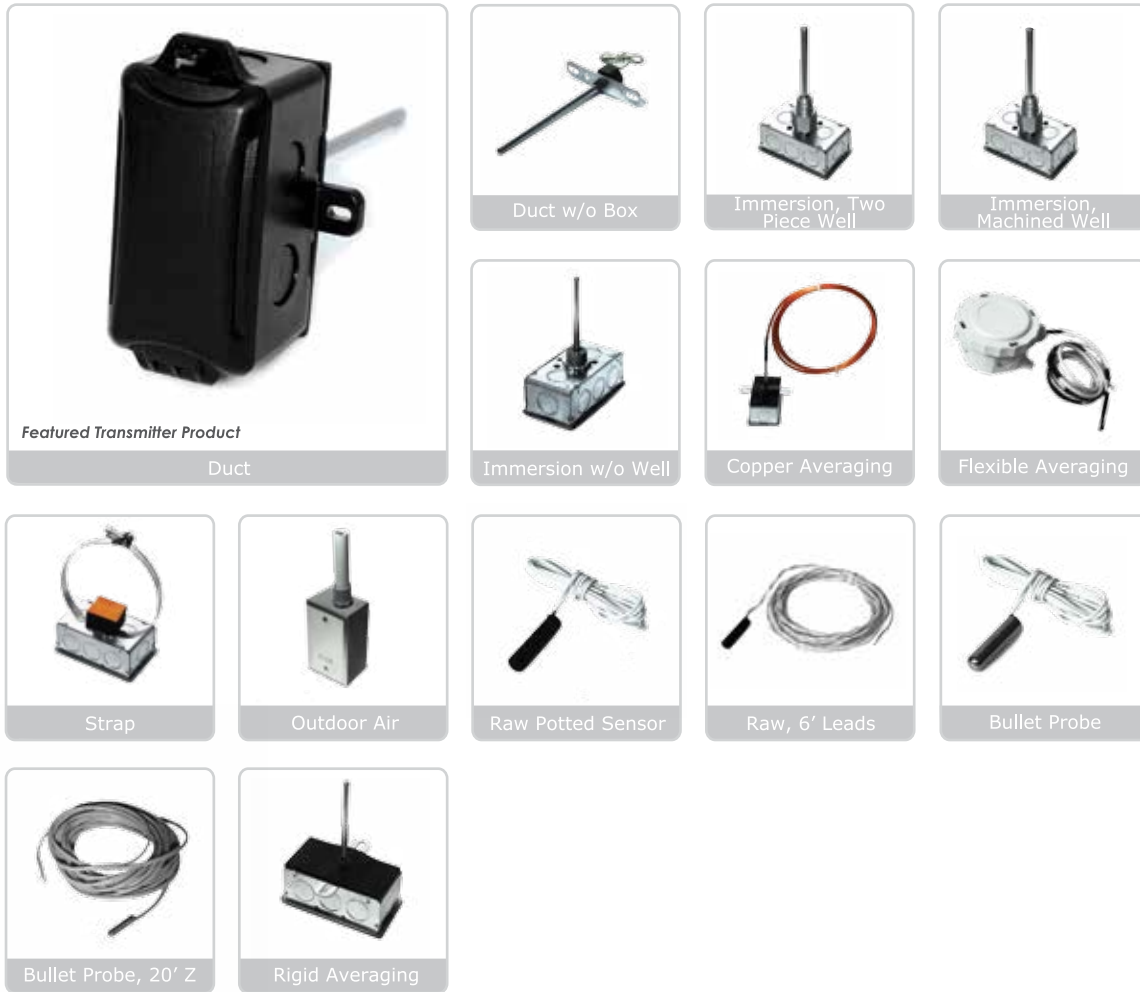

Transmitters

General Mounting

We offers a comprehensive selection of general mounting configurations for Transmitters (see list above). These sensors provide a predictable and accurate output over the specified temperature range. Each sensor configuration is designed and manufactured for long-term quality and performance. Standard features are incorporated such as double encapsulation and etched Teflon leads where applicable. The I-TTM Series offers a matched calibration of the sensor & transmitter, which improves the measurement accuracy.

Specifications

Transmitter Supply Voltage	8.5 to 32 VDC	249 Ohm Load: +13.5 to 32 VDC	499 Ohm Load: +18.5 to 32 VDC
Transmitter Output Current	3 mA-25 mA		
Transmitter Transmitter Input	2-wire Platinum 100/1K Ohm Class A RTD		
Transmitter Transmitter Output	2-wire, Linear 4 to 20 mA DC Current (standard), 1 to 5 VDC, or 2 to 10 VDC		
Calibrated Accuracy	+/-0.2% of full scale for spans <500°F (275°C)	+/-0.5% of full scale for spans >500°F (275°C)	
Temperature Effect	+/-0.02% of full scale for spans >100°F (55°C)	+/-0.04% of full scale for spans <100°F (55°C)	
Transmitter Operating Temperature	-40 to 185°F (-40 to 85°C)		
Transmitter Operating Humidity	0-90% RH non-condensing		
Minimum & Maximum Range Span	minimum: 50°F (28°C)/maximum: 1000°F (550°C)		

Ordering

Select one Series (A), one Configuration (B), one Length (C), one Enclosure (D) & one Output (E). See Thermowell datasheet (I-M-4-6) for proper well selection for all Immersion related sensors. Enclosure options (D) include Plastic Box (PB), Galvanized Box (GD), NEMA 3R (BB), NEMA 4X (4X), & Euro Housing (EH). The Plastic Box (PB) is rated from 0 to 203°F. Once a Sensor Series (A) has been selected, stay within the same row when choosing a Configuration (B) & Length (C). When selecting an Enclosure option (D), stay in previous row as your B & C selections. Choose 1 Output (E).

A Sensor Series

- I-TT100 (Specify Span)
 I-TT1K (Specify Span)
 I-TTM100 (Specify Span)
 I-TTM1K (Specify Span)

B Configuration

- D (Duct) ▶
- DO (Duct w/o Box) ▶
- I (Immersion, Two Piece Well) ▶
- IM (Immersion, Machined Well) ▶
- INW (Immersion w/o Well) ▶
- A (Copper Averaging) ▶
- RA (Rigid Averaging) ▶
- S (Strap) ▶
- O (Outdoor Air) ▶
- W (Raw Potted Sensor) ▶
- W-6' (Raw w/6' Leads) ▶
- BP (Bullet Probe) ▶
- BP-20'Z (BP, 20' of Zip Wire) ▶
-

C Length

- 4" 6" 8" 12" 18" ▶
- 4" 6" 8" 12" 18" ▶
- 2.5" 4" 6" ▶
- 2.5" 4" 6" ▶
- 8' 12' 24' 50' 80' 100' ▶
- 18" 24" 36" ▶
- (No Length) ▶
- (No Length) ▶
- (No Length) ▶
- (No Length) ▶
- (No Length) ▶
- (No Length) ▶

D Enclosure

- PB GD BB 4X EH
- (No Enclosure)
- PB GD BB 4X EH
- PB GD BB 4X EH
- PB GD BB 4X EH
- PB GD BB 4X EH
- PB GD ---- 4X EH
- ---- BB 4X ----
- (No Enclosure)
- (No Enclosure)
- (No Enclosure)
- (No Enclosure)

E Output

- 1 (1 to 5 VDC)
- 2 (2 to 10 VDC)
- 4 (4 to 20 mA)

Build your part number

After completing (A), (B), (C), (D) & (E) from the above table, fill in the "Part Number Table" below. An example part number is offered.

A

B

C

D

E

EXAMPLE: I-TT1K - 30 to 130 -D - 6" - GD - 4

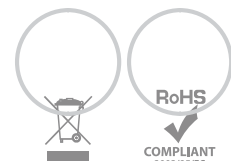

The Plastic Box has a UL94-HB rating. The NEMA 4X enclosure has a UL94-V2 flammability rating. The Euro Housing enclosure has a UL94-V0 flammability rating.